



Office of the City Engineer
Building Department
944 James Street
Woodstock, ON
519-539-1291

POOL FENCE ENCLOSURE REQUIREMENTS

Swimming Pool Permits

If you are wishing to install a privately-owned swimming pool on your property a proper fence must be install that meets the requirements of the City of Woodstock's fence by-law.

You must obtain a swimming pool enclosure permit from The City of Woodstock to ensure that your fence meets the requirements set out in the Fence By-law.

Temporary Fencing

Temporary fencing, such as snow fencing or an approved alternative, is allowed to be used when construction equipment is required to enter the enclosure space, or when a fence is being installed or replaced. Temporary fencing is only allowed for a maximum period of 14 days.

Fence Requirements

The fence cannot facilitate climbing, crawling or any other way that would allow access to your privately owned swimming pool

Chain Link

- If links do not exceed 38mm (1-1/2") it can be used when a fence extends from the ground to a minimum height of 1.5m (5'-0")
- If links do not exceed 50mm (2") it can be used when a fence extends from the ground to a minimum height of 1.8m (6'-0")

Height Requirements

- Pool fence enclosures shall have a minimum height of 5'-0" (1.5m) measured from grade on the outside of the enclosure.
- If the pool fence enclosure is less than 1.8m (6'-0") it shall not be located closer than 1.2m (4'-0") to a climbable object

Pool Fence Enclosure Requirements

Wall – Forming Part of Enclosure

A wall included in part of an enclosure must provide protection for the length that is substituted for fencing.

If a door is located on the wall, within the area that is acting as an enclosure, that door must be equipped with locks, self-closing & latching devices.

Gate Requirements

Gates must be equipped with;

- Self closing devices
- Latch & locking mechanisms

Latch & Locking Mechanisms

- Must independently bring the gate closed to a latched position
- If the latching device is located not less than 1.2m (4'-0") above grade, it can be placed on the outside of the gate.
- The owner & every adult person in care and control of the swimming pool must ensure the gate is kept locked at all times, unless they are present & supervising the swimming pool.

Hydro- Massage Pools

Hydro massage pools can be exempt from the requirements of a fence enclosure provide the massage pool has a rigid cover equipped with a locking device.



Woodstock
ONTARIO • CANADA

THE CITY OF WOODSTOCK

BUILDING DEPARTMENT

DATE ISSUED:
FEB 2013

FENCE REQUIREMENTS – POOL ENCLOSURES

SCALE:
NTS

PAGE NO.:

REAR YARD

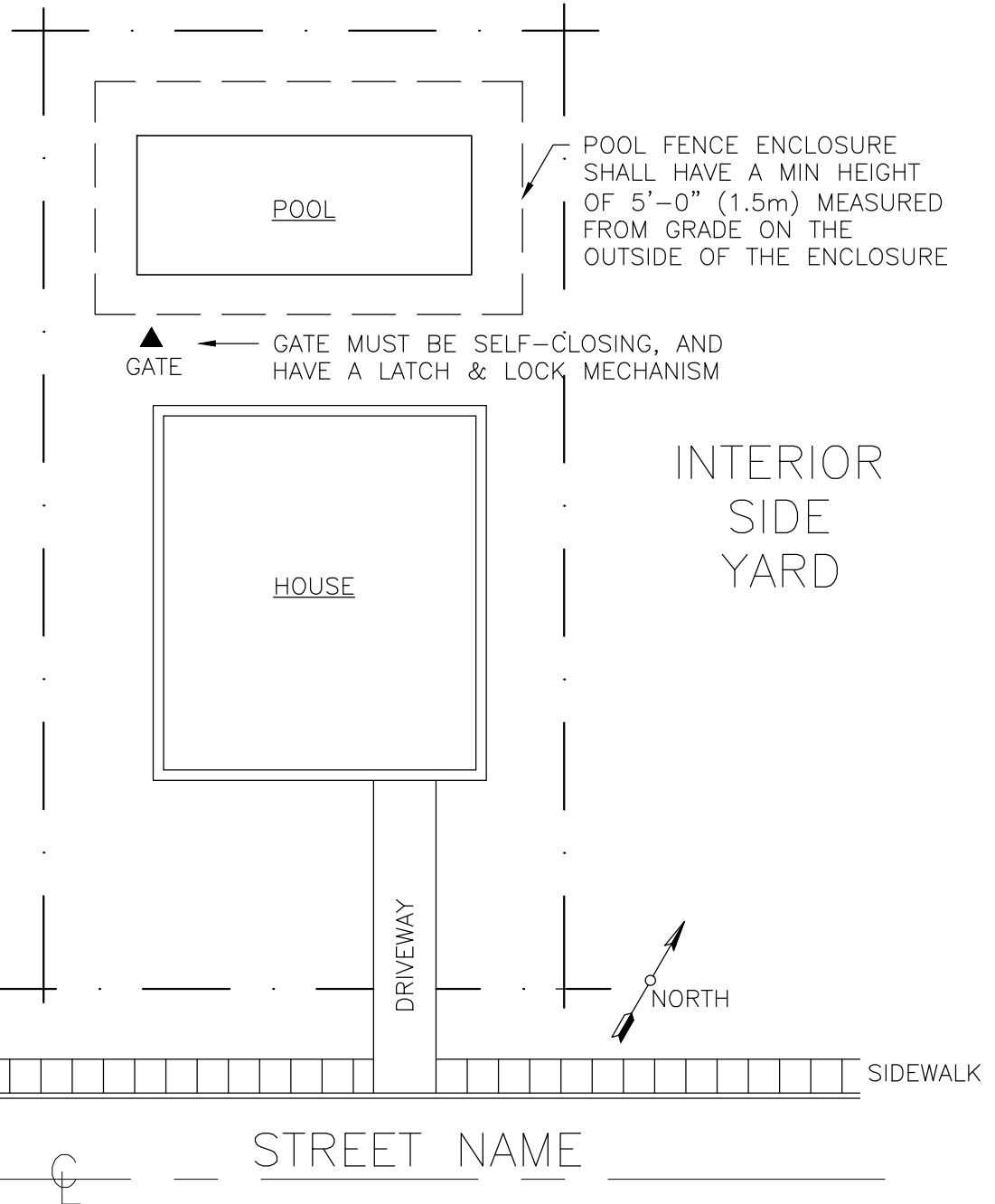

POOL FENCE ENCLOSURE SHALL HAVE A MIN HEIGHT OF 5'-0" (1.5m) MEASURED FROM GRADE ON THE OUTSIDE OF THE ENCLOSURE

GATE MUST BE SELF-CLOSING, AND HAVE A LATCH & LOCK MECHANISM

NOTE:

- IF THE POOL FENCE ENCLOSURE IS LESS THAN 6'-0" (1.8m) IT SHALL NOT BE LOCATED CLOSER THAN 4'-0" (1.2m) TO A CLIMBABLE OBJECT
- SEE DETAIL SHEET FOR CHAIN LINK FENCING REQUIREMENTS

LEGEND:

- - - - - FENCE
- PROPERTY LINE



Woodstock
ONTARIO • CANADA

THE CITY OF WOODSTOCK

BUILDING DEPARTMENT

DATE ISSUED:
FEB 2013

FENCE REQUIREMENTS – POOL ENCLOSURES

SCALE:
NTS

PAGE NO.:

NOTE:

– IF THE FENCE IS CONSTRUCTED TO A HEIGHT LESS THAN 6'-0" (1.8m) IT CANNOT BE LOCATED CLOSER THAN 4'-0" (1.2m) TO A CLIMBABLE OBJECT

– THE LATCH AND LOCK MECHANISM AT THE TOP AND ON THE INSIDE OF THE GATE MUST INDEPENDENTLY BRING THE GATE TO A CLOSED LATCHED POSITION.

– CHAIN LINK FENCING CAN BE USED BUT MUST HAVE THE FOLLOWING REQUIREMENTS:

– FOR CHAIN LINKS NOT EXCEEDING 1.5" (38mm) SHALL BE USED WHEN THE FENCE IS NOT LESS THAN 5'-0" (1.5m) FROM GRADE

– FOR CHAIN LINKS NOT EXCEEDING 2" (50mm) SHALL BE USED WHEN THE FENCE IS NOT LESS 6'-0" (1.8m)

GATES ARE INCLUDED IN THE 5'-0" (1.5m) MIN HEIGHT REQUIREMENT

IF 4'-0" (1.2m) ABOVE GRADE THE LATCH MECHANISM CAN BE LOCATED ON THE OUTSIDE OF THE GATE

GATE MUST BE SELF-CLOSING

LATCH MECHANISM

5'-0" MIN

GRADE

IF A BUILDING WALL FORMS PART OF THE POOL ENCLOSURE IT MUST PROVIDE ADEQUATE PROTECTION FOR ITS ENTIRE LENGTH

IF THE DOOR IS LOCATED IN THE WALL ACTING AS PART OF THE ENCLOSURE & IS LOCATED IN A NON-HABITABLE ROOM IT MUST BE EQUIPPED WITH LOCKS, SELF CLOSING DEVICES, AND LATCHING DEVICES

FENCE DOES NOT FACILITATE ACCESS TO BY, CLIMBING OR, CRAWLING ETC.

5'-0" MIN

GRADE

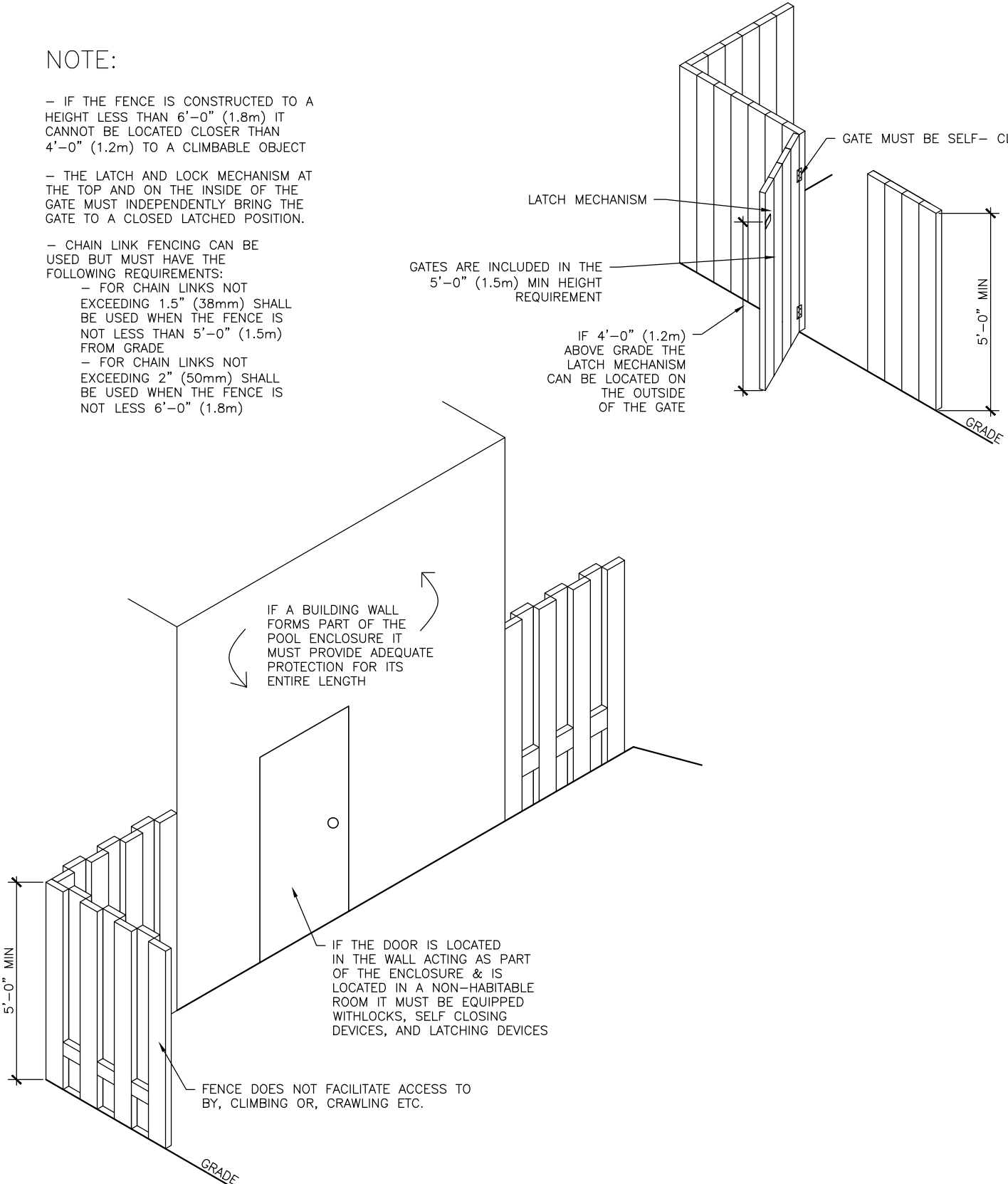



Woodstock
ONTARIO • CANADA

THE CITY OF WOODSTOCK

BUILDING DEPARTMENT

DATE ISSUED:
FEB 2013

FENCE REQUIREMENTS – INTERIOR LOTS

SCALE:
NTS

PAGE NO.:

REAR YARD

REAR & INTERIOR SIDE
HEIGHTS SHALL NOT
EXCEED 2.13m (7'-0")

INTERIOR
SIDE
YARD

INTERIOR
SIDE
YARD

HOUSE

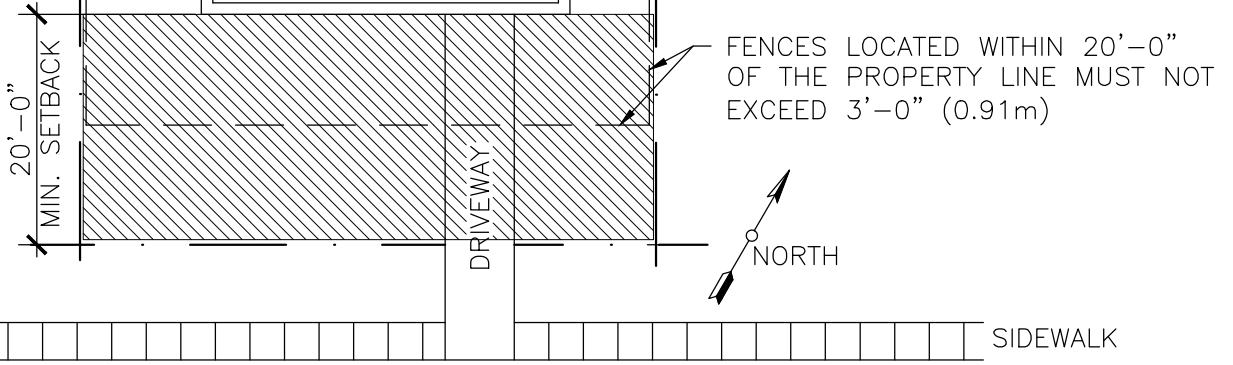

STREET NAME

NOTE:

– FENCES SHALL NOT BLOCK ACCESS TO A PARKING SPACE, UNLESS THE FENCE IS CONSTRUCTED WITH A GATE AT LEAST 2.59m (8.5FT) WIDE ALLOWING ACCESS TO THE PARKING SPACE

LEGEND:

— — — — — FENCE
 — — — — — PROPERTY LINE



Woodstock
ONTARIO • CANADA

THE CITY OF WOODSTOCK

BUILDING DEPARTMENT

DATE ISSUED:
FEB 2013

FENCE REQUIREMENTS- CORNER LOTS

SCALE:
NTS

PAGE NO.:

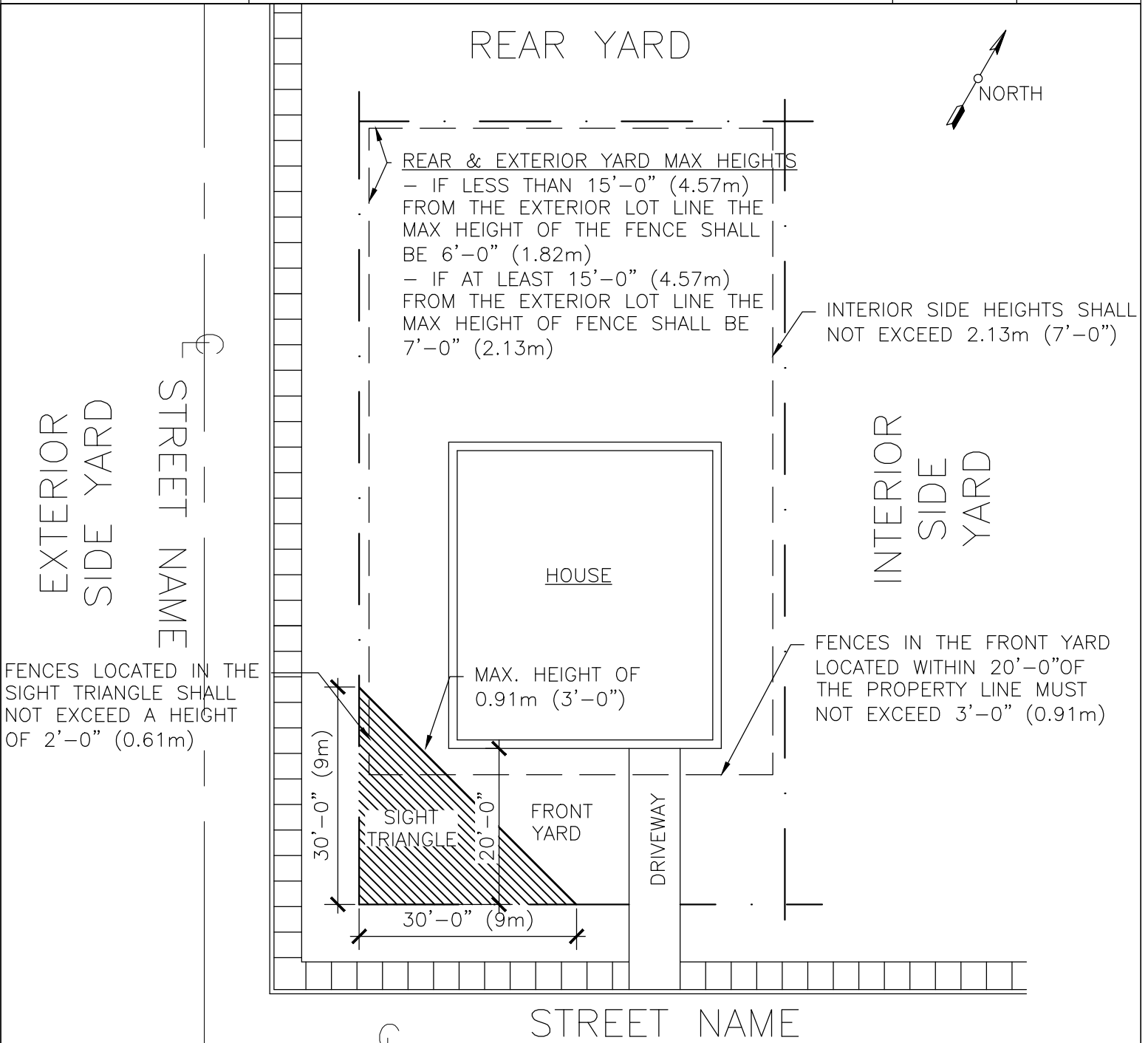

NOTE:

- FENCES SHALL NOT BLOCK ACCESS TO A PARKING SPACE, UNLESS THE FENCE IS CONSTRUCTED WITH A GATE AT LEAST 2.59m (8.5FT) WIDE ALLOWING ACCESS TO THE PARKING SPACE

* SEE PG A7 FOR DRIVEWAY VISIBILITY TRIANGLE REQUIREMENTS



Woodstock
ONTARIO • CANADA

THE CITY OF WOODSTOCK

BUILDING DEPARTMENT

DATE ISSUED:
FEB 2013

FENCE REQUIREMENTS- DRIVEWAY VISIBILITY TRIANGLE

SCALE:
NTS

PAGE NO.:

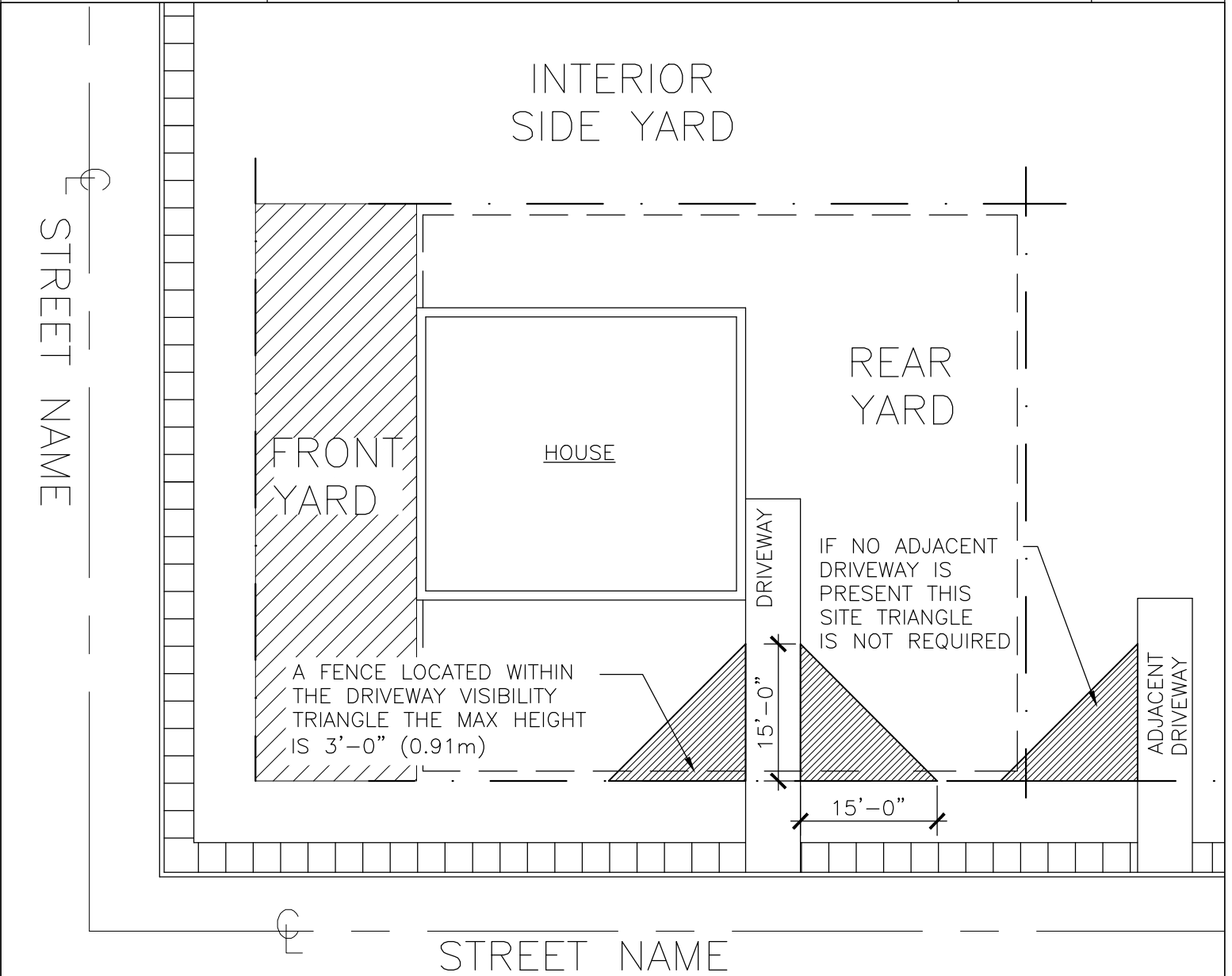

NOTE:

- A FENCE LOCATED IN THE DRIVEWAY VISIBILITY TRIANGLE MAY HAVE A MAX HEIGHT OF 6'-0" (1.8m) IF, THE AREA OF DAYLIGHT VISIBLE THROUGH THE FENCE IS AT LEAST 60% OF THE SURFACE AREA. THE CITY ENGINEER MUST APPROVE SUCH FENCE, AND DETERMINE IT WILL NOT PROVIDE A VISIBILITY PROBLEM



Woodstock
ONTARIO • CANADA

THE CITY OF WOODSTOCK

BUILDING DEPARTMENT

DATE ISSUED:
FEB 2013

FENCE REQUIREMENTS – ABUTTING COMMERCIAL, INDUSTRIAL
OR INSTITUTIONAL LOTS

SCALE:
NTS

PAGE NO.:

REAR YARD

* ABUTTING A COMMERCIAL, INDUSTRIAL,
OR INSTITUTIONAL PROPERTY

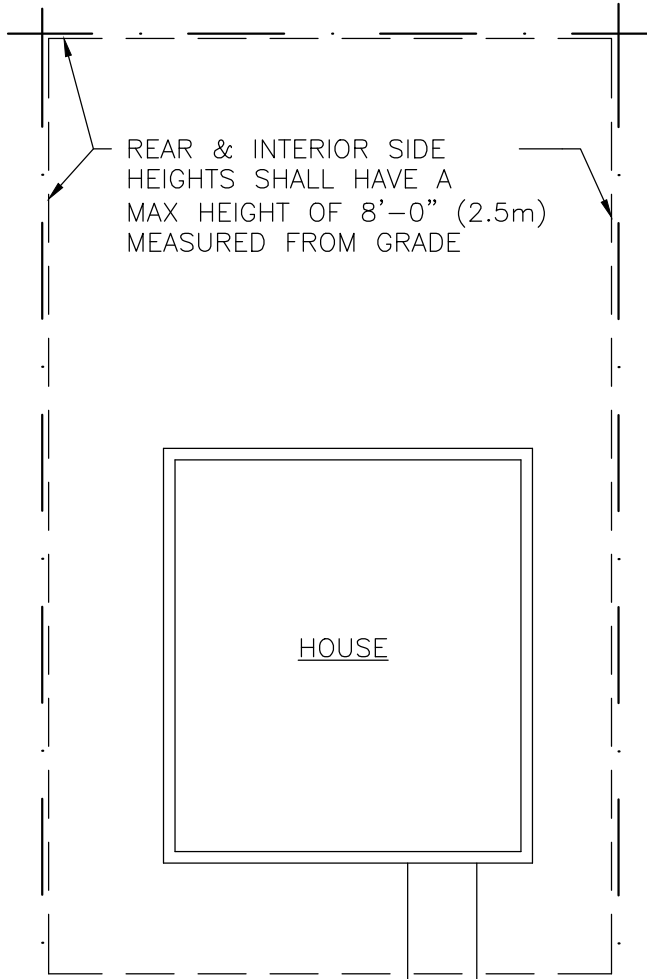

INTERIOR
SIDE
YARD

INTERIOR
SIDE
YARD

HOUSE



DRIVEWAY

NORTH

SIDEWALK

STREET NAME

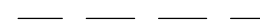
LEGEND:

 FENCE
 PROPERTY LINE